

# Equal Tee

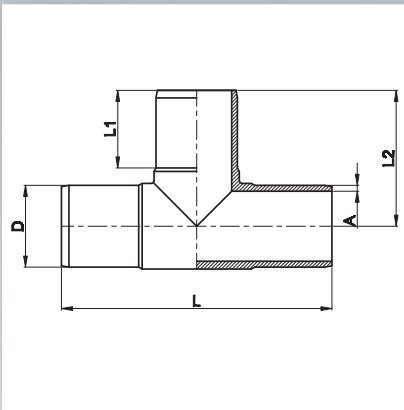

## PE100 | SDR 11 | Water PN 16 | Gas 10 Bar

D (mm)	L (mm)	L1 (mm)	L2 (mm)	A (mm)	Weight (kg)	Box Quantity
20	135	41	69	3.0	0.035	50
25	145	41	74	3.0	0.050	40
32	157	44	80	3.0	0.080	30
40	183	49	93	3.7	0.130	50
50	222	55	113	4.6	0.210	47
63	239	63	123	5.8	0.380	36
75	273	70	139	6.8	0.570	22
90	301	79	153	8.2	0.910	14
110	337	82	171	10.0	1.580	14
125	367	87	186	11.4	2.215	8
140	384	92	195	12.7	2.735	6
160	428	98	217	14.6	4.070	4
180	472	105	239	16.4	5.750	3
200	488	112	247	18.2	7.375	2
225	534	120	270	20.5	10.140	2
250	597	129	302	22.7	14.100	2
280	698	139	353	25.4	21.550	1
315	726	150	388	28.6	27.000	1
355	829	167	414	32.2	39.800	1
400	913	198	457	36.3	42.450	1
450	954	198	477	40.9	77.300	1
500	1050	218	525	45.4	101.000	1
560	1380	400	500	50.9	141.000	1
630	1450	400	540	57.2	187.000	1
710	1710	400	650	64.5	318.000	1
800	1850	400	400	72.7	409.100	1

Every effort has been made to ensure the information in this brochure is correct at the date of issue. Fusion operates a policy of continuous product improvement and range extension and, therefore, reserves the right to modify product specifications in line with market requirements.

# Equal Tee



## PE100 | SDR 17 | Water PN 10 | Gas 6 Bar

D (mm)	L (mm)	L1 (mm)	L2 (mm)	A (mm)	Weight (kg)	Box Quantity
50	184	57	90	3.0	0.147	47
63	239	63	123	3.8	0.295	36
75	273	70	139	4.5	0.425	22
90	301	79	153	5.4	0.660	14
110	337	82	171	6.6	1.190	14
125	367	87	186	7.4	1.585	8
140	384	92	195	8.3	1.990	6
160	428	98	217	9.5	2.940	4
180	472	105	239	10.7	4.025	3
200	488	112	247	11.9	5.250	2
225	534	120	270	13.4	7.480	2
250	597	129	302	14.8	9.900	2
280	698	139	353	16.6	15.700	1
315	726	150	388	18.7	19.000	1
355	818	165	408	21.1	25.850	1
400	910	197	455	23.7	35.015	1
450	955	197	478	26.7	56.000	1
500	1050	218	525	29.7	71.000	1
560	1380	400	500	32.9	96.000	1
630	1450	400	540	37.1	127.000	1
710	1710	400	650	41.8	220.000	1
800	1850	400	400	47.1	281.000	1

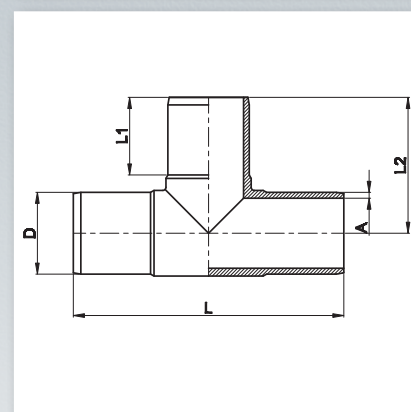

Every effort has been made to ensure the information in this brochure is correct at the date of issue. Fusion operates a policy of continuous product improvement and range extension and, therefore, reserves the right to modify product specifications in line with market requirements.